



SIRIUS soft starter 200-690 V 210 A, 24 V AC/DC spring-type terminals







product brand name	SIRIUS
product category	Hybrid switching devices
product designation	Soft starter
product type designation	3RW55
manufacturer's article number	<ul style="list-style-type: none"> • of high feature HMI module usable • of communication module PROFINET standard usable • of communication module PROFINET high-feature usable • of communication module PROFIBUS usable • of communication module Modbus TCP usable • of communication module Modbus RTU usable • of communication module Ethernet/IP • of circuit breaker usable at 400 V • of circuit breaker usable at 500 V • of circuit breaker usable at 400 V at inside-delta circuit • of circuit breaker usable at 500 V at inside-delta circuit • of the gG fuse usable up to 690 V • of the gG fuse usable at inside-delta circuit up to 500 V • of full range R fuse link for semiconductor protection usable up to 690 V • of back-up R fuse link for semiconductor protection usable up to 690 V
General technical data	<p> 3RW5980-0HF00 3RW5980-0CS00 3RW5950-0CH00 3RW5980-0CP00 3RW5980-0CT00 3RW5980-0CR00 3RW5980-0CE00 3VA2325-7MN32-0AA0: Type of coordination 1, Iq = 65 kA, CLASS 10 3VA2325-7MN32-0AA0: Type of coordination 1, Iq = 65 kA, CLASS 10 3VA2440-7MN32-0AA0: Type of coordination 1, Iq = 65 kA, CLASS 10 3VA2440-7MN32-0AA0: Type of coordination 1, Iq = 65 kA, CLASS 10 2x3NA3354-6; Type of coordination 1, Iq = 65 kA 2x3NA3354-6; Type of coordination 1, Iq = 65 kA 3NE1230-2; for supply systems up to 500 V; type of coordination 2, Iq = 65 kA 3NE3333; Type of coordination 2, Iq = 65 kA </p>
starting voltage [%]	20 ... 100 %
stopping voltage [%]	50 ... 50 %
start-up ramp time of soft starter	0 ... 360 s
ramp-down time of soft starter	0 ... 360 s
start torque [%]	10 ... 100 %
stopping torque [%]	10 ... 100 %
torque limitation [%]	20 ... 200 %
current limiting value [%] adjustable	125 ... 800 %
breakaway voltage [%] adjustable	40 ... 100 %
breakaway time adjustable	0 ... 2 s
number of parameter sets	3

accuracy class acc. to IEC 61557-12	5 %
certificate of suitability	
• CE marking	Yes
• UL approval	Yes
• CSA approval	Yes
product component	
• HMI-High Feature	Yes
• is supported HMI-High Feature	Yes
product feature integrated bypass contact system	Yes
number of controlled phases	3
trip class	CLASS 10A / 10E (default) / 20E / 30E; acc. to IEC 60947-4-2
current unbalance limiting value [%]	10 ... 60 %
ground-fault monitoring limiting value [%]	10 ... 95 %
recovery time after overload trip adjustable	60 ... 1 800 s
buffering time in the event of power failure	
• for main current circuit	100 ms
• for control circuit	100 ms
idle time adjustable	0 ... 255 s
insulation voltage rated value	690 V
degree of pollution	3, acc. to IEC 60947-4-2
impulse voltage rated value	8 kV
blocking voltage of the thyristor maximum	1 800 V
service factor	1.15
surge voltage resistance rated value	8 kV
maximum permissible voltage for safe isolation	
• between main and auxiliary circuit	690 V; does not apply for thermistor connection
utilization category acc. to IEC 60947-4-2	AC 53a
shock resistance	15 g / 11 ms, from 6 g / 11 ms with potential contact lifting
vibration resistance	15 mm up to 6 Hz; 2 g up to 500 Hz
reference code acc. to IEC 81346-2	Q
Substance Prohibitance (Date)	15.02.2018 00:00:00
product function	
• ramp-up (soft starting)	Yes
• ramp-down (soft stop)	Yes
• breakaway pulse	Yes
• adjustable current limitation	Yes
• creep speed in both directions of rotation	Yes
• pump ramp down	Yes
• DC braking	Yes
• motor heating	Yes
• slave pointer function	Yes
• trace function	Yes
• intrinsic device protection	Yes
• motor overload protection	Yes; Full motor protection (thermistor motor protection and electronic motor overload protection)
• evaluation of thermistor motor protection	Yes; Type A PTC or Klaxon / Thermoclick
• inside-delta circuit	Yes; Only up to 600 V operating voltage
• auto-RESET	Yes
• manual RESET	Yes
• remote reset	Yes
• communication function	Yes
• operating measured value display	Yes
• event list	Yes
• error logbook	Yes
• via software parameterizable	Yes
• via software configurable	Yes
• screw terminal	No
• spring-type terminal	Yes
• PROFInergy	Yes; in connection with the PROFINET Standard and PROFINET High-

<ul style="list-style-type: none"> • firmware update • removable terminal for control circuit • voltage ramp • torque control • combined braking • analog output • programmable control inputs/outputs • condition monitoring • automatic parameterisation • application wizards • alternative run-down • emergency operation mode • reversing operation • soft starting at heavy starting conditions 	Feature communication modules Yes Yes Yes Yes Yes Yes; 4 ... 20 mA (default) / 0 ... 10 V Yes Yes Yes Yes Yes Yes Yes Yes
Power Electronics	
operational current	
<ul style="list-style-type: none"> • at 40 °C rated value • at 40 °C rated value minimum • at 50 °C rated value • at 60 °C rated value 	210 A 42 A 186 A 170 A
operational current at inside-delta circuit	
<ul style="list-style-type: none"> • at 40 °C rated value • at 50 °C rated value • at 60 °C rated value 	364 A 322 A 294 A
operating voltage	
<ul style="list-style-type: none"> • rated value • at inside-delta circuit rated value 	200 ... 690 V 200 ... 600 V
relative negative tolerance of the operating voltage	-15 %
relative positive tolerance of the operating voltage	10 %
relative negative tolerance of the operating voltage at inside-delta circuit	-15 %
relative positive tolerance of the operating voltage at inside-delta circuit	10 %
operating power for 3-phase motors	
<ul style="list-style-type: none"> • at 230 V at 40 °C rated value • at 230 V at inside-delta circuit at 40 °C rated value • at 400 V at 40 °C rated value • at 400 V at inside-delta circuit at 40 °C rated value • at 500 V at 40 °C rated value • at 500 V at inside-delta circuit at 40 °C rated value • at 690 V at 40 °C rated value 	55 kW 110 kW 110 kW 200 kW 132 kW 250 kW 200 kW
Operating frequency 1 rated value	50 Hz
Operating frequency 2 rated value	60 Hz
relative negative tolerance of the operating frequency	-10 %
relative positive tolerance of the operating frequency	10 %
minimum load [%]	10 %; Relative to set I _e
power loss [W] for rated value of the current at AC	
<ul style="list-style-type: none"> • at 40 °C after startup • at 50 °C after startup • at 60 °C after startup 	63 W 56 W 51 W
power loss [W] at AC at current limitation 350 %	
<ul style="list-style-type: none"> • at 40 °C during startup • at 50 °C during startup • at 60 °C during startup 	3 550 W 2 967 W 2 605 W
type of the motor protection	Electronic, tripping in the event of thermal overload of the motor
Control circuit/ Control	
type of voltage of the control supply voltage	AC/DC
control supply voltage at AC	

<ul style="list-style-type: none"> • at 50 Hz rated value • at 60 Hz rated value 	24 V
relative negative tolerance of the control supply voltage at AC at 50 Hz	-20 %
relative positive tolerance of the control supply voltage at AC at 50 Hz	20 %
relative negative tolerance of the control supply voltage at AC at 60 Hz	-20 %
relative positive tolerance of the control supply voltage at AC at 60 Hz	20 %
control supply voltage frequency	50 ... 60 Hz
relative negative tolerance of the control supply voltage frequency	-10 %
relative positive tolerance of the control supply voltage frequency	10 %
control supply voltage <ul style="list-style-type: none"> • at DC rated value 	24 V
relative negative tolerance of the control supply voltage at DC	-20 %
relative positive tolerance of the control supply voltage at DC	20 %
control supply current in standby mode rated value	440 mA
holding current in bypass operation rated value	720 mA
locked-rotor current at close of bypass contact maximum	6.7 A
inrush current peak at application of control supply voltage maximum	7.5 A
duration of inrush current peak at application of control supply voltage	20 ms
design of the overvoltage protection	Varistor
design of short-circuit protection for control circuit	4 A gG fuse (Icu=1 kA), 6 A quick-acting fuse (Icu=1 kA), C1 miniature circuit breaker (Icu= 600 A), C6 miniature circuit breaker (Icu= 300 A); Is not part of scope of supply
Inputs/ Outputs	
number of digital inputs <ul style="list-style-type: none"> • parameterizable 	4 4
number of inputs for thermistor connection	1; Type A PTC or Klixon / Thermoclick
<ul style="list-style-type: none"> • number of digital outputs • number of digital outputs parameterizable • number of digital outputs not parameterizable 	4 3 1
digital output version	3 normally-open contacts (NO) / 1 changeover contact (CO)
number of analog outputs	1
switching capacity current of the relay outputs <ul style="list-style-type: none"> • at AC-15 at 250 V rated value • at DC-13 at 24 V rated value 	3 A 1 A
Installation/ mounting/ dimensions	
mounting position	Vertical (can be rotated +/- 90° and tilted forward or backward +/- 22.5°)
fastening method	screw fixing
height	393 mm
width	210 mm
depth	203 mm
required spacing with side-by-side mounting <ul style="list-style-type: none"> • forwards • backwards • upwards • downwards • at the side 	10 mm 0 mm 100 mm 75 mm 5 mm
weight without packaging	10.2 kg
Connections/ Terminals	
type of electrical connection <ul style="list-style-type: none"> • for main current circuit 	busbar connection

<ul style="list-style-type: none"> • for control circuit 	spring-loaded terminals
width of connection bar maximum	45 mm
wire length for thermistor connection <ul style="list-style-type: none"> • with conductor cross-section = 0.5 mm² maximum • with conductor cross-section = 1.5 mm² maximum • with conductor cross-section = 2.5 mm² maximum 	50 m 150 m 250 m
type of connectable conductor cross-sections <ul style="list-style-type: none"> • for DIN cable lug for main contacts stranded • for DIN cable lug for main contacts finely stranded 	2x (50 ... 240 mm ²) 2x (70 ... 240 mm ²)
type of connectable conductor cross-sections <ul style="list-style-type: none"> • for control circuit solid • for control circuit finely stranded with core end processing • at AWG cables for control circuit solid • at AWG cables for control circuit finely stranded with core end processing 	2x (0.25 ... 1.5 mm ²) 2x (0.25 ... 1.5 mm ²) 2x (24 ... 16) 2x (24 ... 16)
wire length <ul style="list-style-type: none"> • between soft starter and motor maximum • at the digital inputs at DC maximum 	800 m 1 000 m
tightening torque <ul style="list-style-type: none"> • for main contacts with screw-type terminals • for auxiliary and control contacts with screw-type terminals 	14 ... 24 N·m 0.8 ... 1.2 N·m
tightening torque [lbf·in] <ul style="list-style-type: none"> • for main contacts with screw-type terminals • for auxiliary and control contacts with screw-type terminals 	124 ... 210 lbf·in 7 ... 10.3 lbf·in
Ambient conditions	
installation altitude at height above sea level maximum	2 000 m; Derating as of 1000 m, see catalog
ambient temperature <ul style="list-style-type: none"> • during operation • during storage and transport 	-25 ... +60 °C; Please observe derating at temperatures of 40 °C or above -40 ... +80 °C
environmental category <ul style="list-style-type: none"> • during operation acc. to IEC 60721 • during storage acc. to IEC 60721 • during transport acc. to IEC 60721 	3K6 (no ice formation, only occasional condensation), 3C3 (no salt mist), 3S2 (sand must not get into the devices), 3M6 1K6 (only occasional condensation), 1C2 (no salt mist), 1S2 (sand must not get inside the devices), 1M4 2K2, 2C1, 2S1, 2M2 (max. fall height 0.3 m)
EMC emitted interference	acc. to IEC 60947-4-2: Class A
Communication/ Protocol	
communication module is supported <ul style="list-style-type: none"> • PROFINET standard • PROFINET high-feature • EtherNet/IP • Modbus RTU • Modbus TCP • PROFIBUS 	Yes Yes Yes Yes Yes Yes
UL/CSA ratings	
manufacturer's article number <ul style="list-style-type: none"> • of circuit breaker <ul style="list-style-type: none"> — usable for Standard Faults at 460/480 V according to UL — usable for High Faults at 460/480 V according to UL — usable for Standard Faults at 460/480 V at inside-delta circuit according to UL — usable for High Faults at 460/480 V at inside-delta circuit according to UL — usable for Standard Faults at 575/600 V according to UL 	Siemens type: 3VA53, max. 400 A or 3VA54, max. 600 A; I _q = 10 kA Siemens type: 3VA53, max. 400 A or 3VA54, max. 600 A; I _q max = 65 kA Siemens type: 3VA53, max. 400 A or 3VA54, max. 600 A; I _q = 10 kA Siemens type: 3VA53, max. 400 A or 3VA54, max. 600 A; I _q max = 65 kA Siemens type: 3VA53, max. 400 A or 3VA54, max. 600 A; I _q = 10 kA

<div><div>— usable for High Faults at 575/600 V at inside-delta circuit according to UL</div><div>— usable for Standard Faults at 575/600 V at inside-delta circuit according to UL</div></div> <div><div>• of the fuse</div><div><div>— usable for Standard Faults up to 575/600 V according to UL</div><div>— usable for High Faults up to 575/600 V according to UL</div><div>— usable for Standard Faults at inside-delta circuit up to 575/600 V according to UL</div><div>— usable for High Faults at inside-delta circuit up to 575/600 V according to UL</div></div></div>	<div>Siemens type: 3VA53, max. 400 A or 3VA54, max. 600 A; Iq max = 65 kA</div> <div>Siemens type: 3VA53, max. 400 A or 3VA54, max. 600 A; Iq = 10 kA</div>		
<div><div>operating power [hp] for 3-phase motors</div><div><div>• at 200/208 V at 50 °C rated value</div><div>• at 220/230 V at 50 °C rated value</div><div>• at 460/480 V at 50 °C rated value</div><div>• at 575/600 V at 50 °C rated value</div><div>• at 200/208 V at inside-delta circuit at 50 °C rated value</div><div>• at 220/230 V at inside-delta circuit at 50 °C rated value</div><div>• at 460/480 V at inside-delta circuit at 50 °C rated value</div><div>• at 575/600 V at inside-delta circuit at 50 °C rated value</div></div></div>	<div>60 hp</div> <div>60 hp</div> <div>150 hp</div> <div>150 hp</div> <div>100 hp</div> <div>125 hp</div> <div>250 hp</div> <div>300 hp</div>		
<div><div>contact rating of auxiliary contacts according to UL</div></div>	<div>R300-B300</div>		
<div>Safety related data</div>			
<div><div>protection class IP on the front acc. to IEC 60529</div></div>	<div>IP00; IP20 with cover</div>		
<div><div>touch protection on the front acc. to IEC 60529</div></div>	<div>finger-safe, for vertical contact from the front with cover</div>		
<div><div>electromagnetic compatibility</div></div>	<div>acc. to IEC 60947-4-2</div>		
<div>ATEX</div>			
<div><div>certificate of suitability</div><div><div>• ATEX</div><div>• IECEx</div><div>• according to ATEX directive 2014/34/EU</div></div></div>	<div>Yes</div> <div>Yes</div> <div>BVS 18 ATEX F 003 X</div>		
<div><div>type of protection according to ATEX directive 2014/34/EU</div></div>	<div>II (2)G [Ex eb Gb] [Ex db Gb] [Ex pxb Gb], II (2)D [Ex tb Db] [Ex pxb Db], I (M2) [Ex db Mb]</div>		
<div><div>hardware fault tolerance acc. to IEC 61508 relating to ATEX</div></div>	<div>0</div>		
<div><div>PFDAvg with low demand rate acc. to IEC 61508 relating to ATEX</div></div>	<div>0.008</div>		
<div><div>PFHD with high demand rate acc. to EN 62061 relating to ATEX</div></div>	<div>0.0000005 1/h</div>		
<div><div>Safety Integrity Level (SIL) acc. to IEC 61508 relating to ATEX</div></div>	<div>SIL1</div>		
<div><div>T1 value for proof test interval or service life acc. to IEC 61508 relating to ATEX</div></div>	<div>3 y</div>		
<div>Certificates/ approvals</div>			
<div><div>General Product Approval</div></div>	<div>EMC</div>	<div>For use in hazardous locations</div>	
<div><div><div></div><div></div><div></div><div></div><div></div><div></div></div></div>			
<div><div>For use in hazardous locations</div></div>	<div><div>Declaration of Conformity</div></div>	<div><div>Test Certificates</div></div>	<div><div>Marine / Shipping</div></div>



[Type Test Certificates/Test Report](#)



other

[Confirmation](#)

Further information

Information- and Downloadcenter (Catalogs, Brochures,...)

<https://www.siemens.com/ic10>

Industry Mall (Online ordering system)

<https://mall.industry.siemens.com/mall/en/en/Catalog/product?mlfb=3RW5543-2HA06>

Cax online generator

<http://support.automation.siemens.com/WW/CAXorder/default.aspx?lang=en&mlfb=3RW5543-2HA06>

Service&Support (Manuals, Certificates, Characteristics, FAQs,...)

<https://support.industry.siemens.com/cs/ww/en/ps/3RW5543-2HA06>

Image database (product images, 2D dimension drawings, 3D models, device circuit diagrams, EPLAN macros, ...)

http://www.automation.siemens.com/bilddb/cax_de.aspx?mlfb=3RW5543-2HA06&lang=en

Characteristic: Tripping characteristics, I²t, Let-through current

<https://support.industry.siemens.com/cs/ww/en/ps/3RW5543-2HA06/char>

Characteristic: Installation altitude

<http://www.automation.siemens.com/bilddb/index.aspx?view=Search&mlfb=3RW5543-2HA06&objecttype=14&gridview=view1>

Simulation Tool for Soft Starters (STS)

<https://support.industry.siemens.com/cs/ww/en/view/101494917>

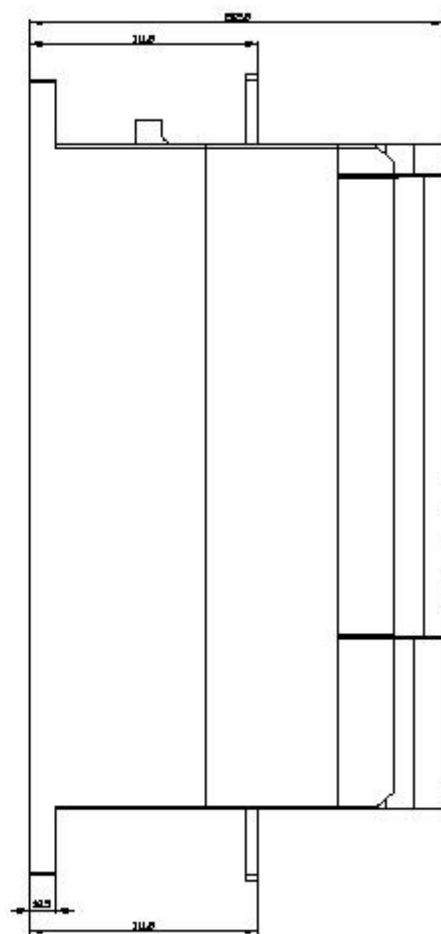
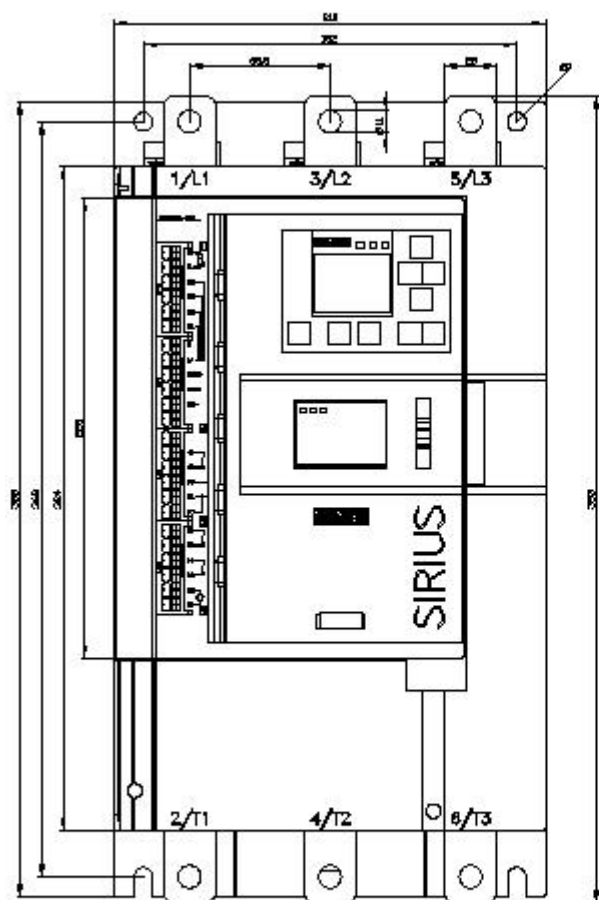

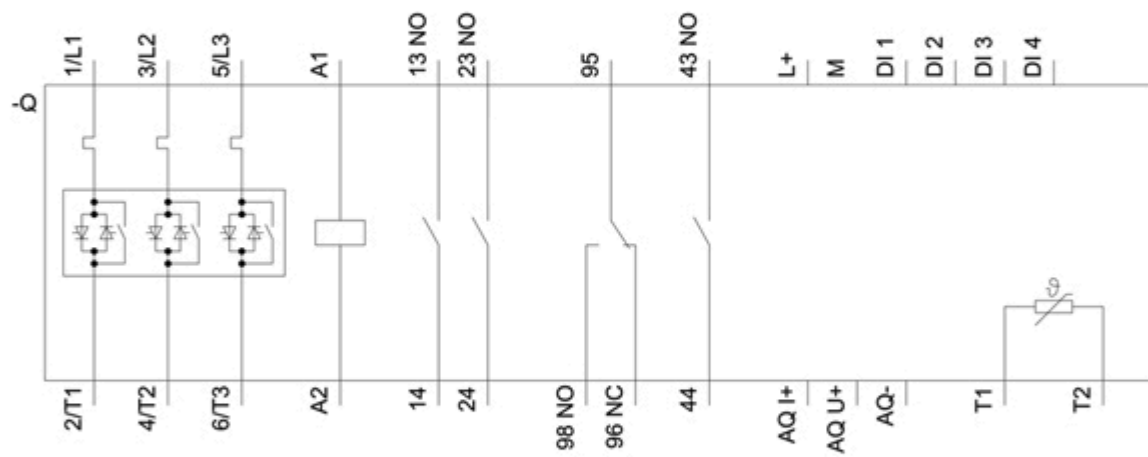

last modified:

3/9/2021